

GROUND FLOOR PLAN  
 BUILT UP AREA- 433 SQFT  
 PARKING+ ENTRANCE FOYER-735 SQFT

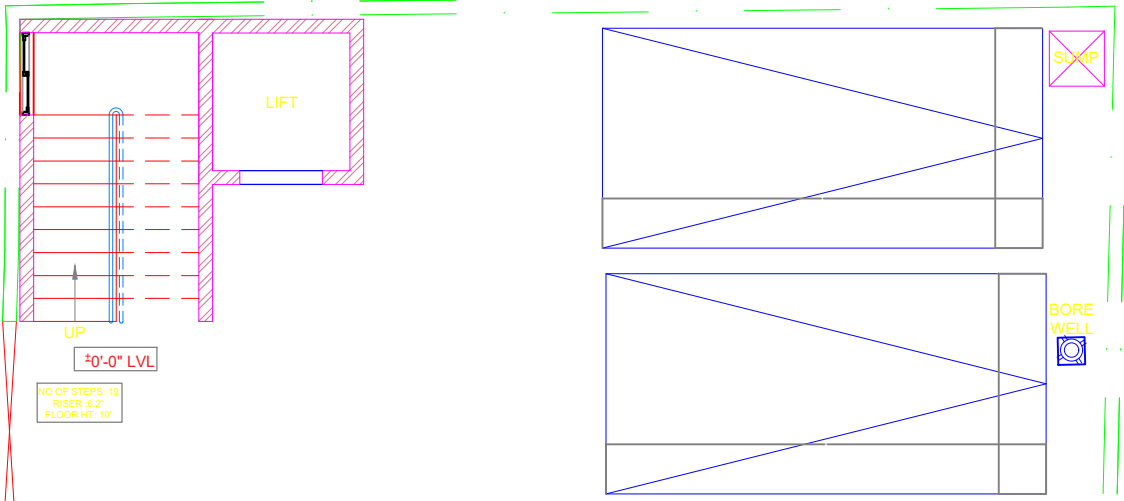

ROAD

8'-0" WIDE  
 MAIN GATE



±0'-0" LVL  
 NO OF STEPS: 19  
 RISER: 6.2"  
 FLOOR HT: 10"

ROLLING SHUTTER

SHOP 1  
 10'-10" x 9'-3"

SHOP 2  
 10'-0" x 8'-3"

SHOP 3  
 10'-0" x 8'-3"

GYPSEUM WALL  
 TO DETAIL IN INTERIORS

GYPSEUM WALL  
 TO DETAIL IN INTERIORS

ROLLING SHUTTER

ROLLING SHUTTER

4'-0" WIDE  
 WICKET GATE

ROAD

E:\BNB\REFERENCE\logo bnb.png

Clayworks, 16/2 ,2nd Floor,  
 Sobha Alexander Plaza,  
 Commissariat Rd,  
 Ashok Nagar,  
 Bengaluru, Karnataka 560025

NOTES:  
 -All dimensions are in  
 feet and inches.  
 -Drawings to be read  
 & not measured.

Details will supercede  
 all drawings.

Project  
**Residence for Mr. BALAJI**

Designed by: Ar. AISHWARYA  
 RAM

Project No.  
 CRN 111264

Sheet.  
 No.  
 1

Date  
 09/02/2022

Drawing Title R7  
 GROUND FLOOR PLAN

Scale  
 NTS